

One Kit. Keep part bags separate!

To fast build Assign teammates separate bags



Base

2-3 People
Hard Difficulty



Lid

1-2 People
Medium Difficulty



Balloon Pop

2-3 People
Medium Difficulty



Remote

1-2 People
Medium Difficulty

!Magnets in bags!

Don't mix from other bags

2.2 Use these screws to
attach to plastic parts

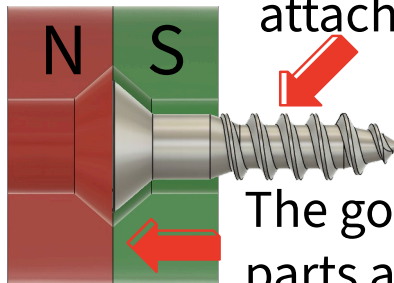

The goal is to have the
parts attract together

All screw-head will be in the countersunk of magnet

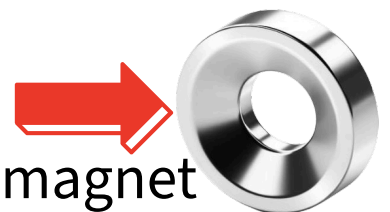

Base

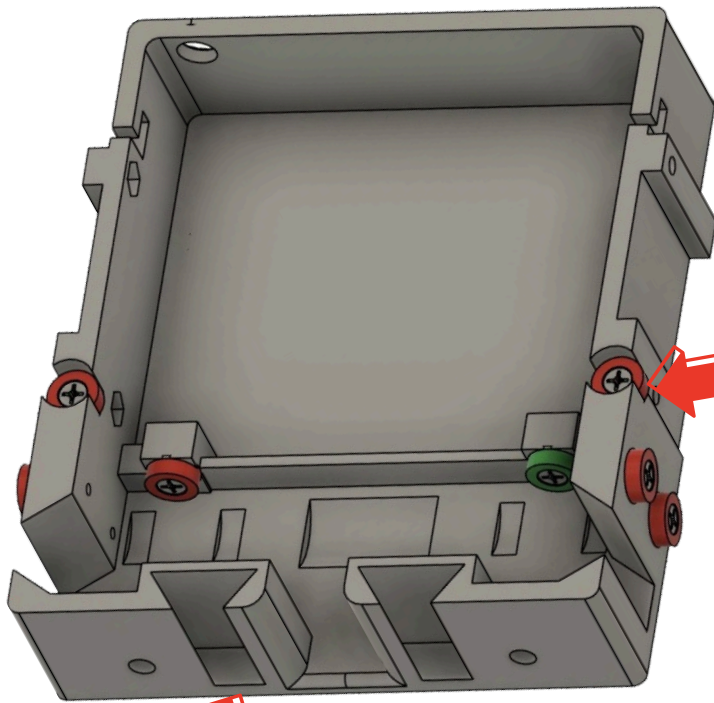

Magnets



Install these magnets only.
Lid will magnet to these
when complete.

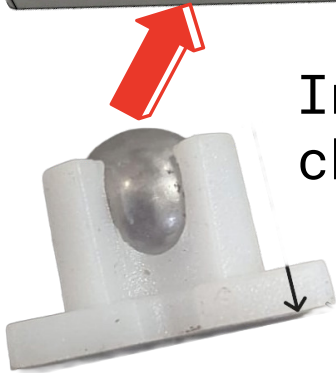

Install Caster Wheel on bottom of
chassis

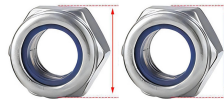

Wrench



Drive motors

1. Use one of the long screws to guide the press fit nuts into chassis.
Do this with all 4 nuts before installing motors. Remove screw but
make sure nuts don't pop out hold with finger when mounting
motors

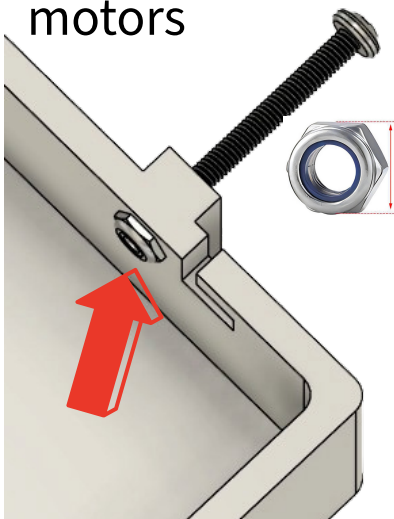

Base PG 2

2. Mount drive motors to chassis

TIP: Hold nut with finger while attaching motors

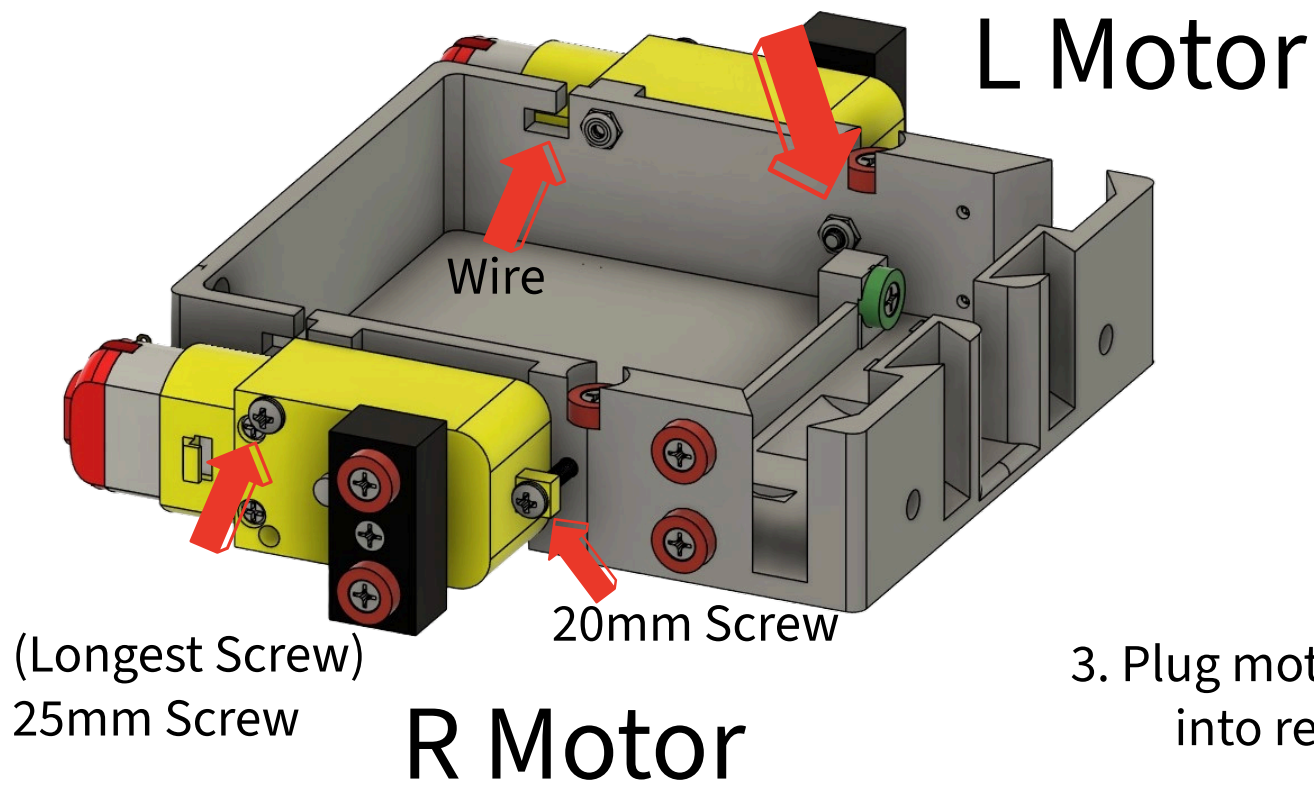

3. Plug motors & Plug into receiver

4. Press wheels onto motor shaft



Battery Input
R - Right Drive Motor
L - Left Drive Motor

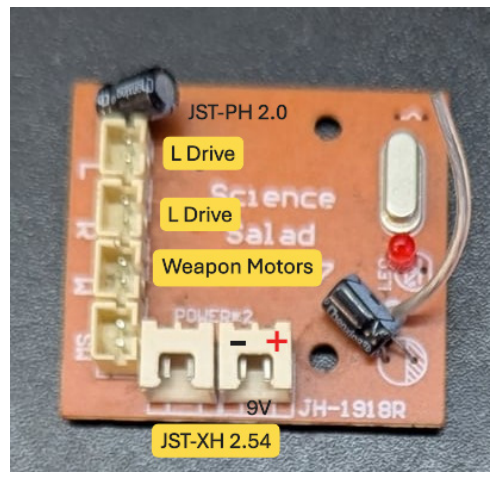
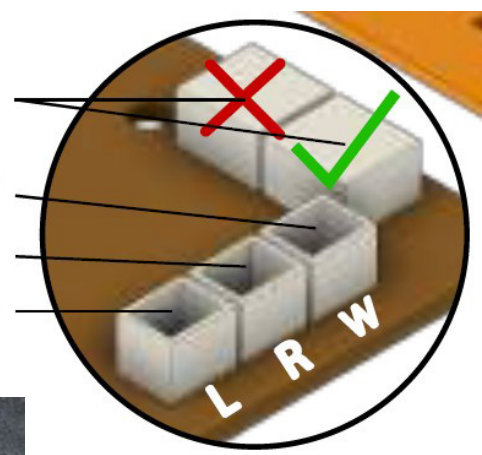

LID

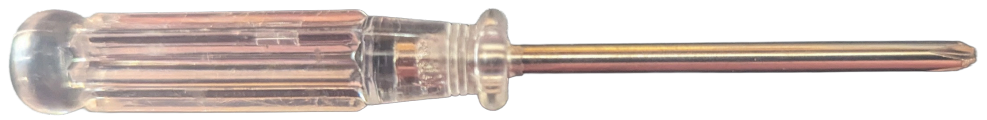

Nuts do not need to be fully tighten

Screws & nuts for lid



Magnets

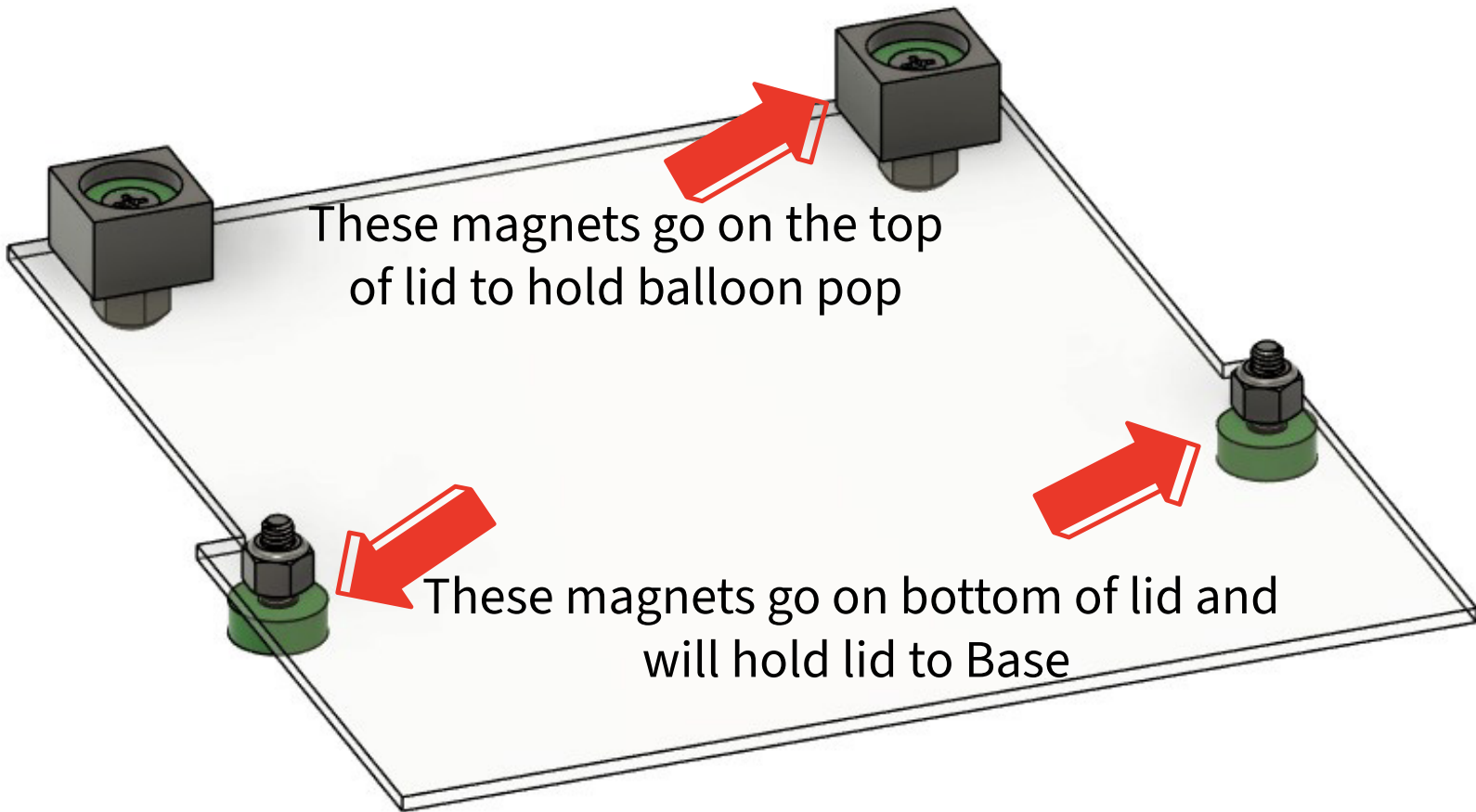

Balloon POP

Nuts do not need to be fully tighten

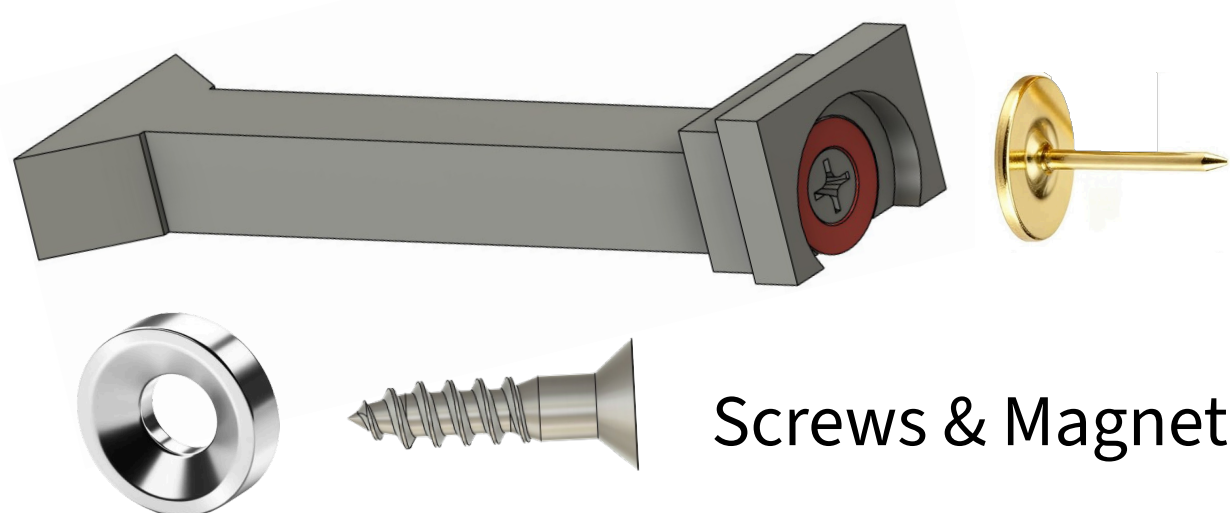
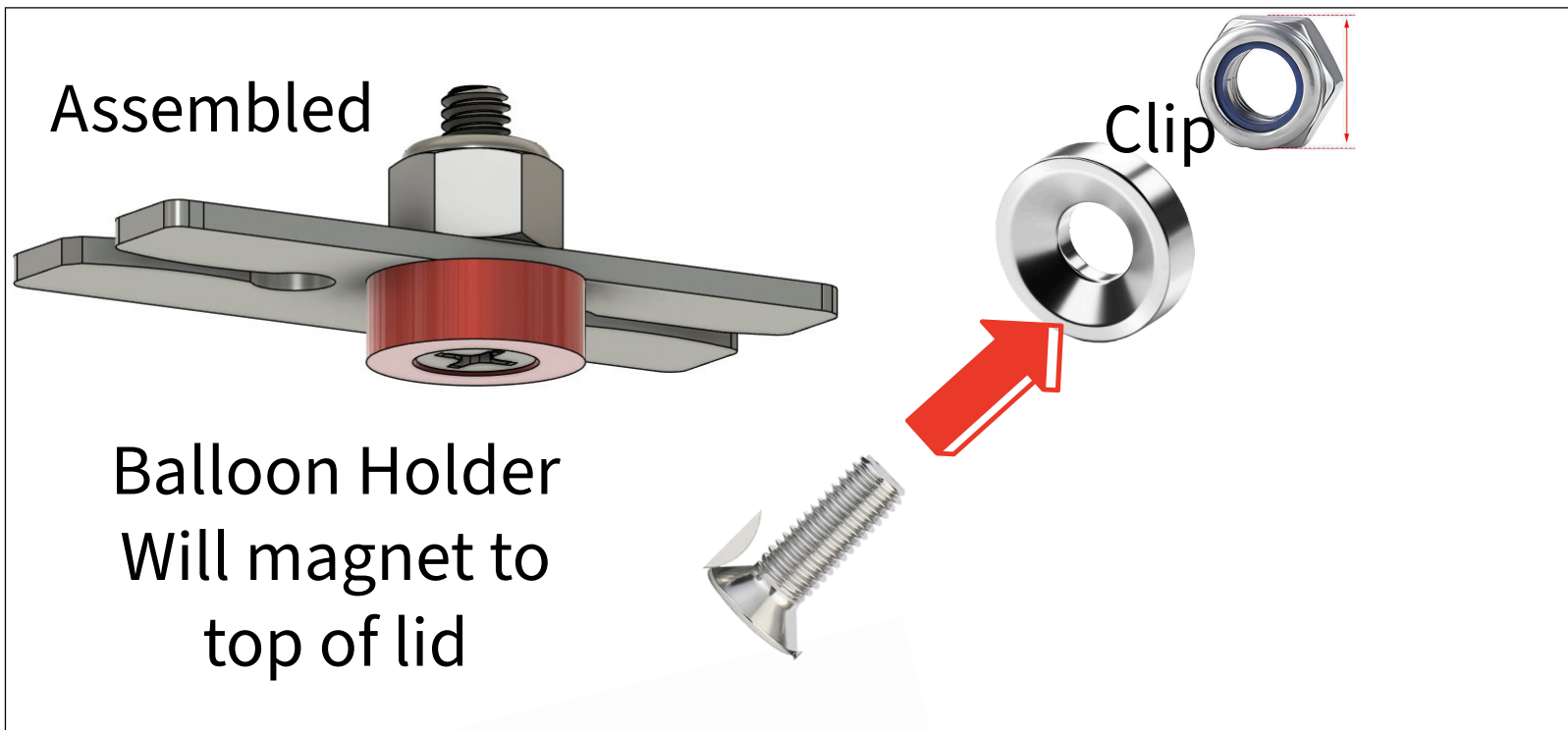
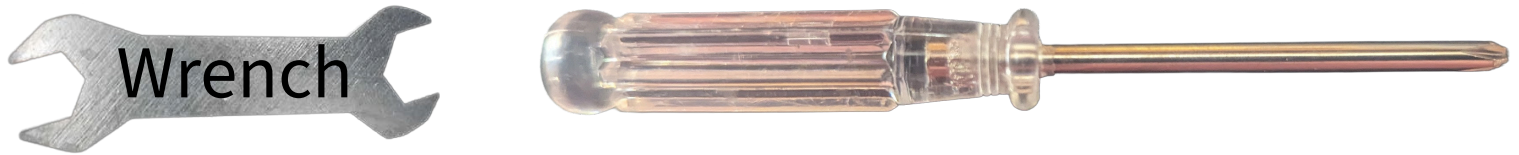

5: Remote

